

PLAT
BOOK

PERRY COUNTY ILLINOIS

Published by *General Map Company* Rockford, Illinois

— Distributed by —

PERRY COUNTY FARM BUREAU

PERRY COUNTY ILLINOIS

PLAT BOOK

PERRY COUNTY ILLINOIS

PERRY COUNTY FARM BUREAU



INDEX MAP OF 1952
PERRY COUNTY ILLINOIS

T.4 S. - R.4W. PAGE 7	T.4 S. - R.3W. PAGE 6	T.4 S. - R.2W. PAGE 5	T.4 S. - R.1W. PAGE 4
T.5 S. - R.4W. PAGE 11	T.5 S. - R.3W. PAGE 10	T.5 S. - R.2W. PAGE 9	T.5 S. - R.1W. PAGE 8
T.6 S. - R.4W. PAGE 15	T.6 S. - R.3W. PAGE 14	T.6 S. - R.2W. PAGE 13	T.6 S. - R.1W. PAGE 12



PERRY COUNTY ILLINOIS

— LEGEND —

-  FEDERAL HIGHWAYS
-  STATE HIGHWAYS
-  STATE AID IMPROVED

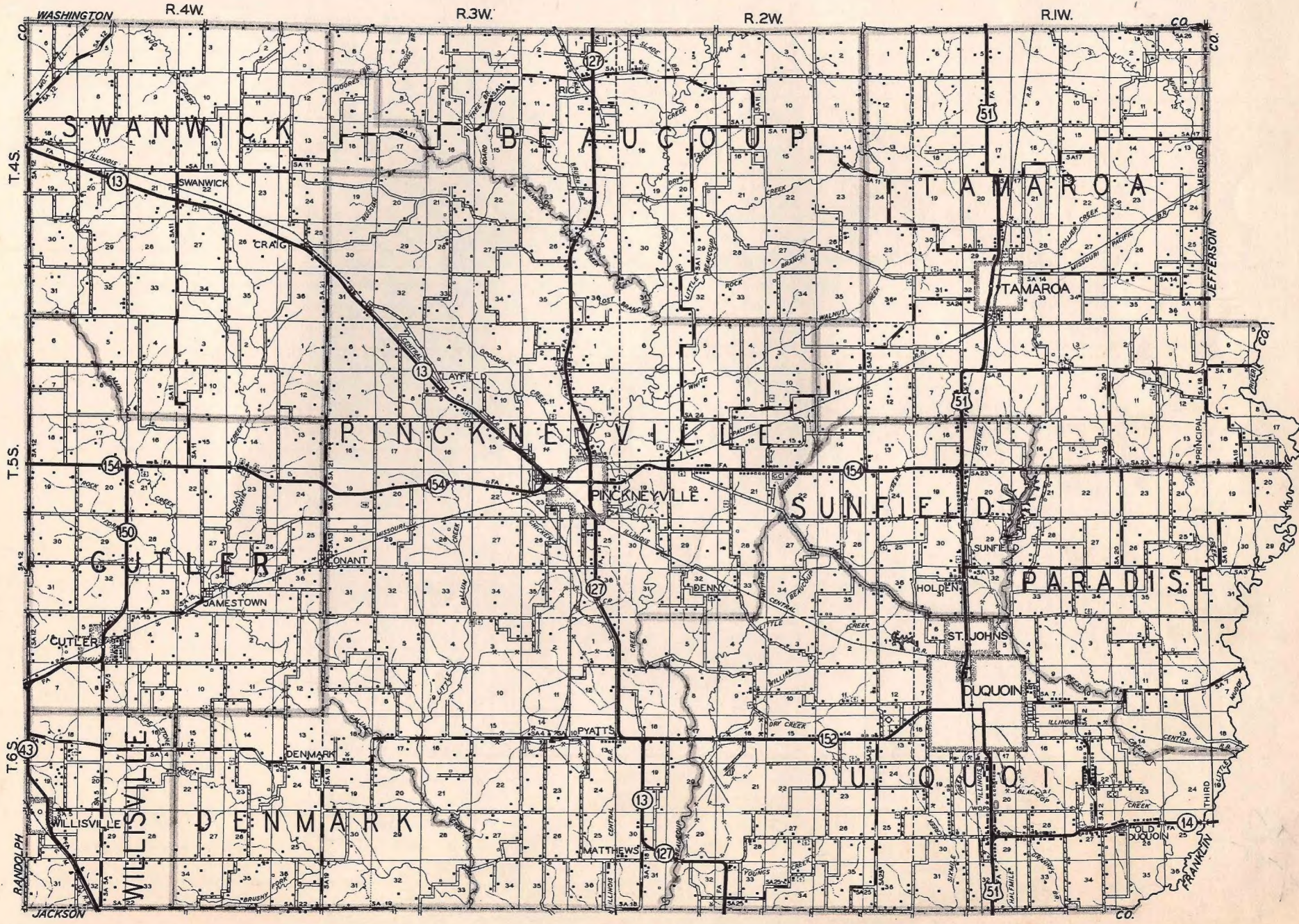

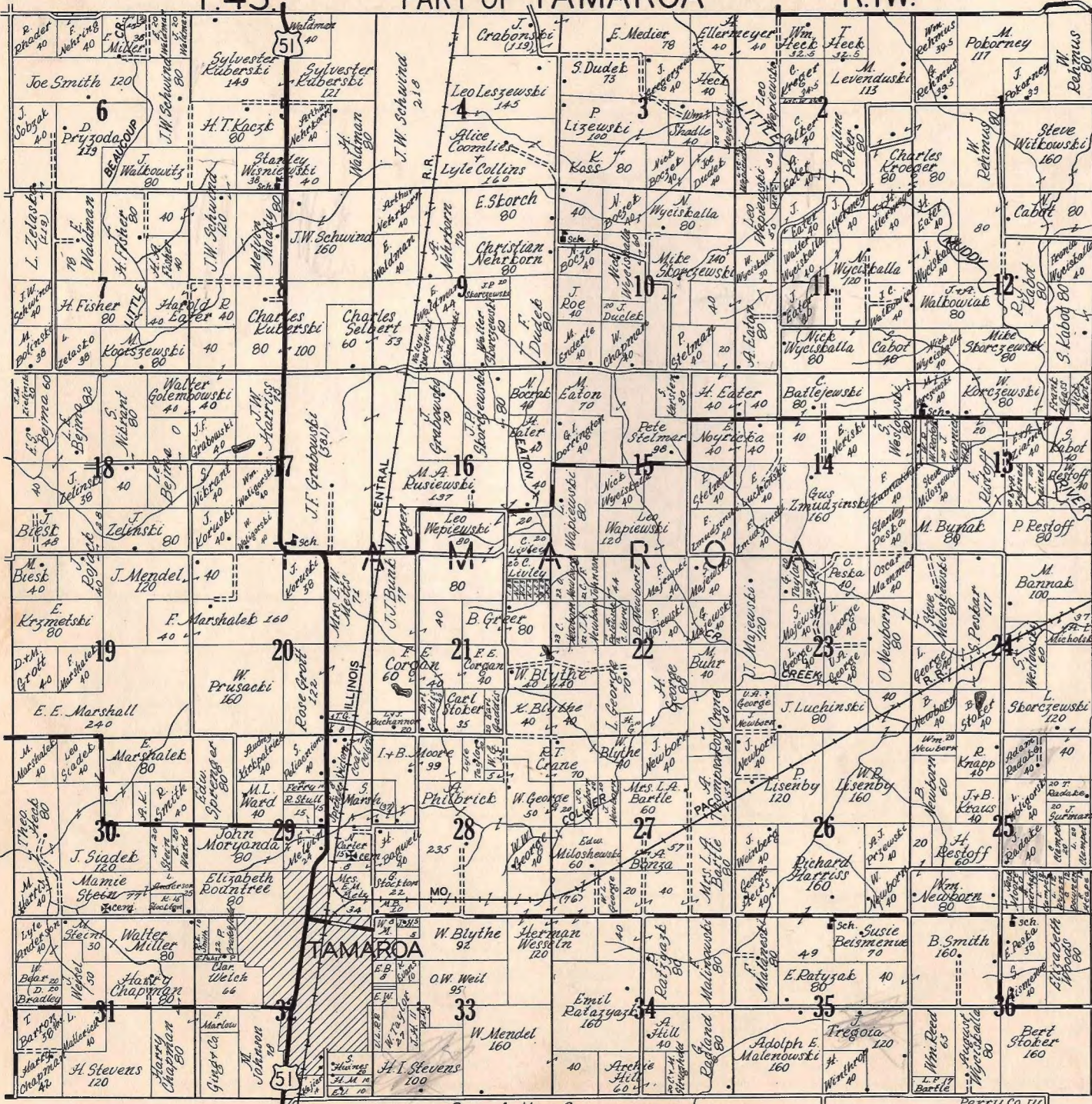

T. 4S. PARTS OF BEAUCOUP-TAMAROA-PINCKNEYVILLE R. 2W. 5

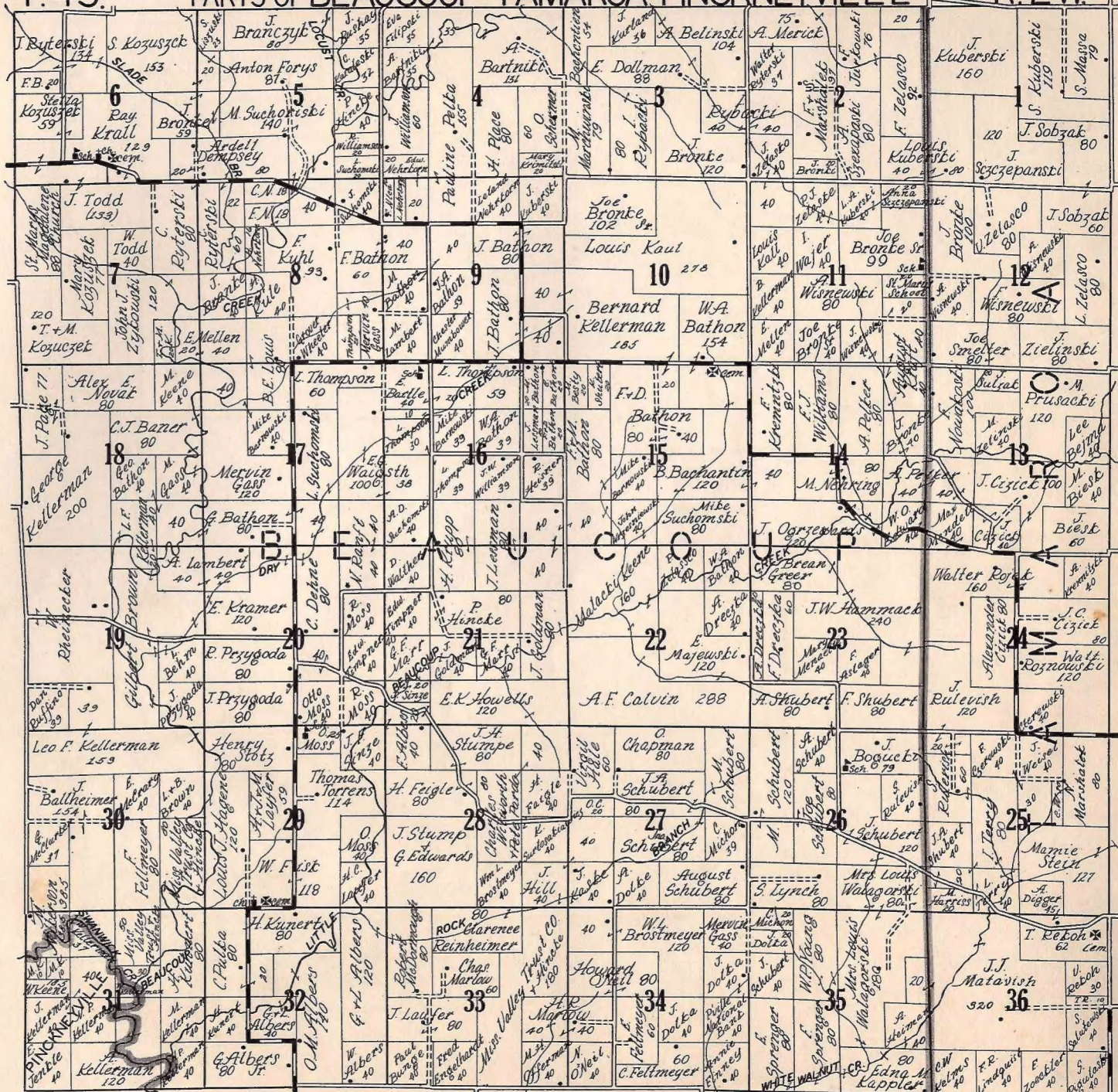

6 T. 4S. PARTS OF SWANWICK-BEAUCOUP - PINCKNEYVILLE R. 3W.



44000
 44076000/136
 15
 2300
 440
 600
 160
 192
 280
 264
 16

T.4S.

PART OF SWANWICK

R.4W.

7

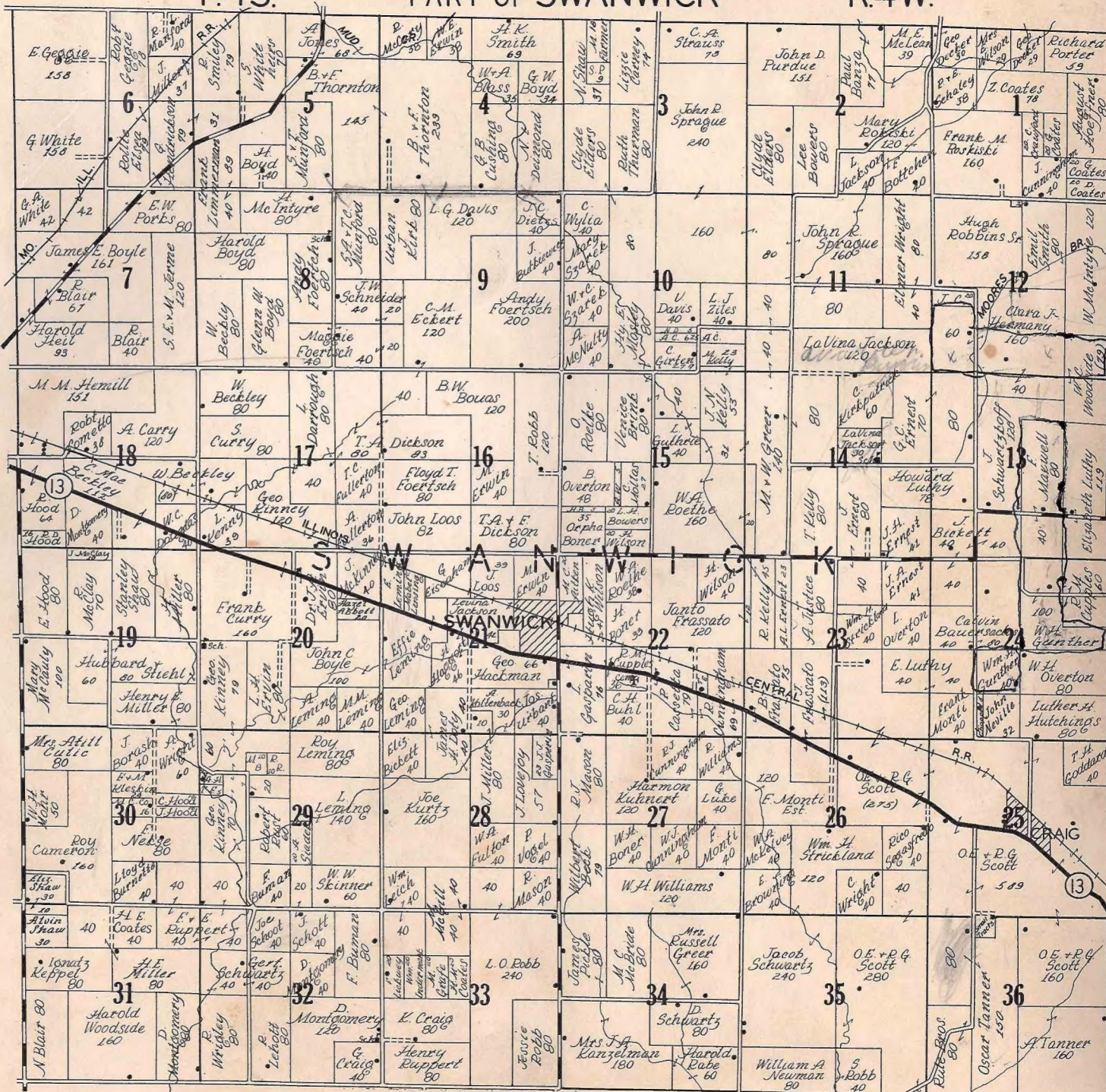

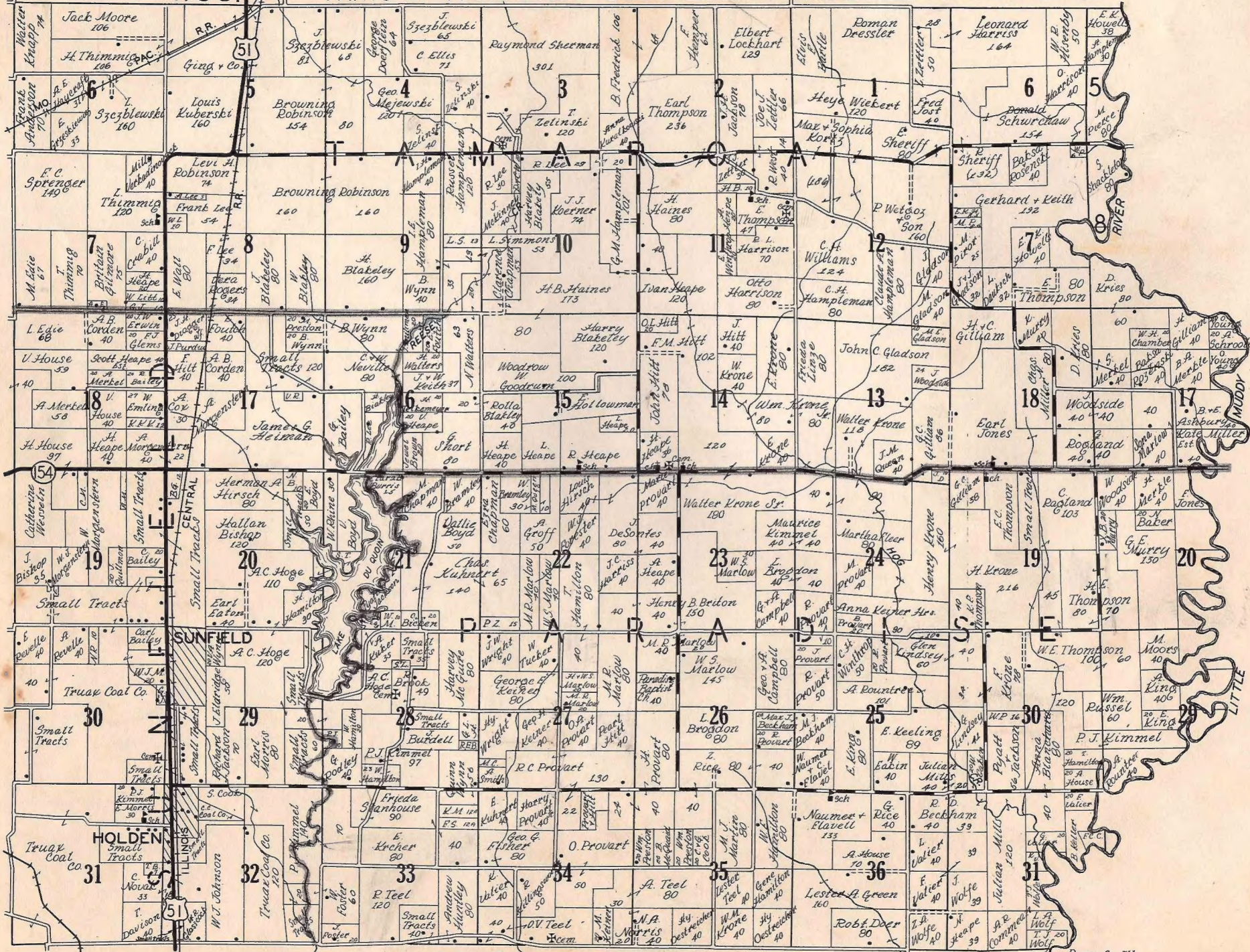

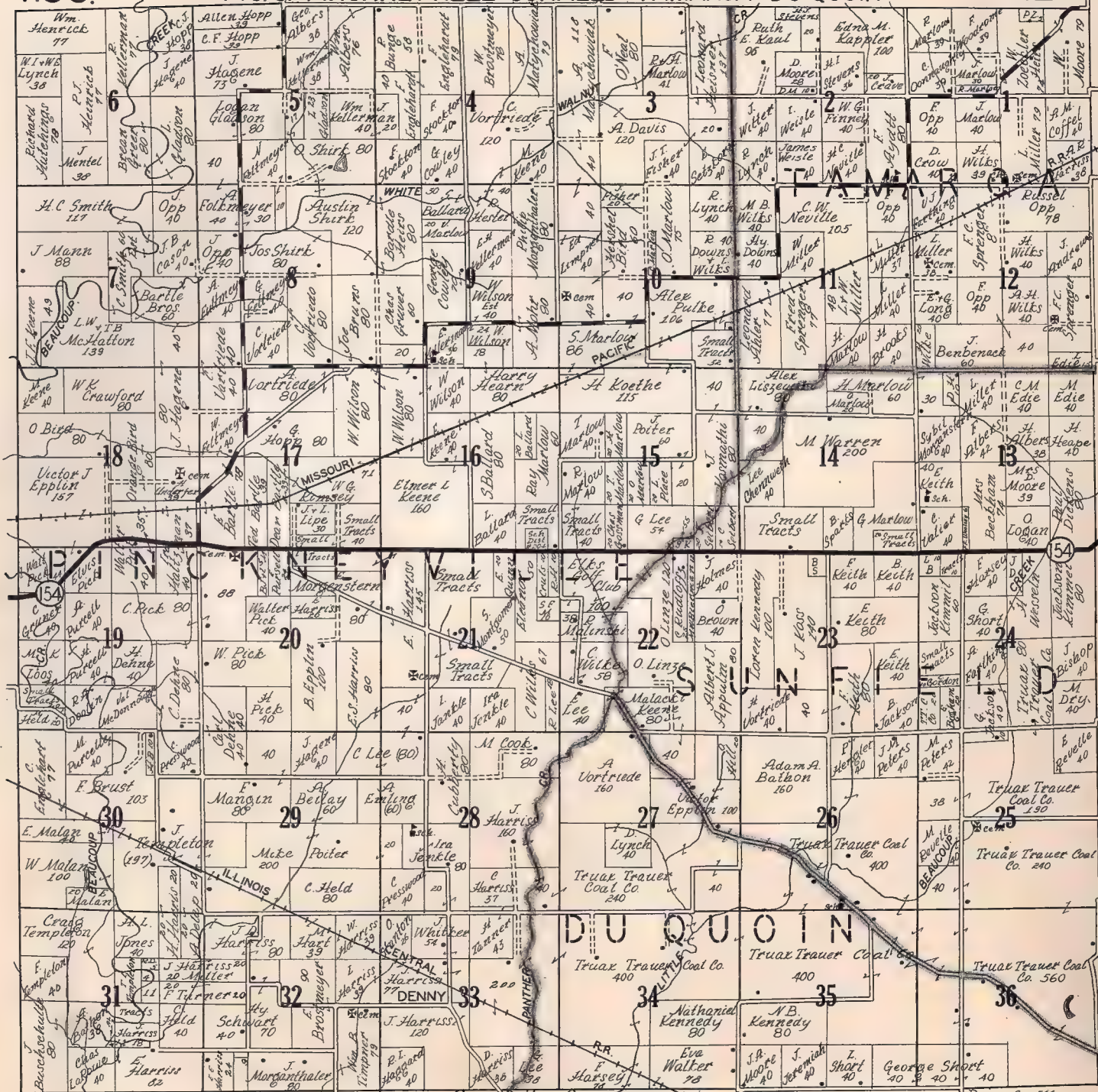

T.5S. PART OF PINCKNEYVILLE R.3W.

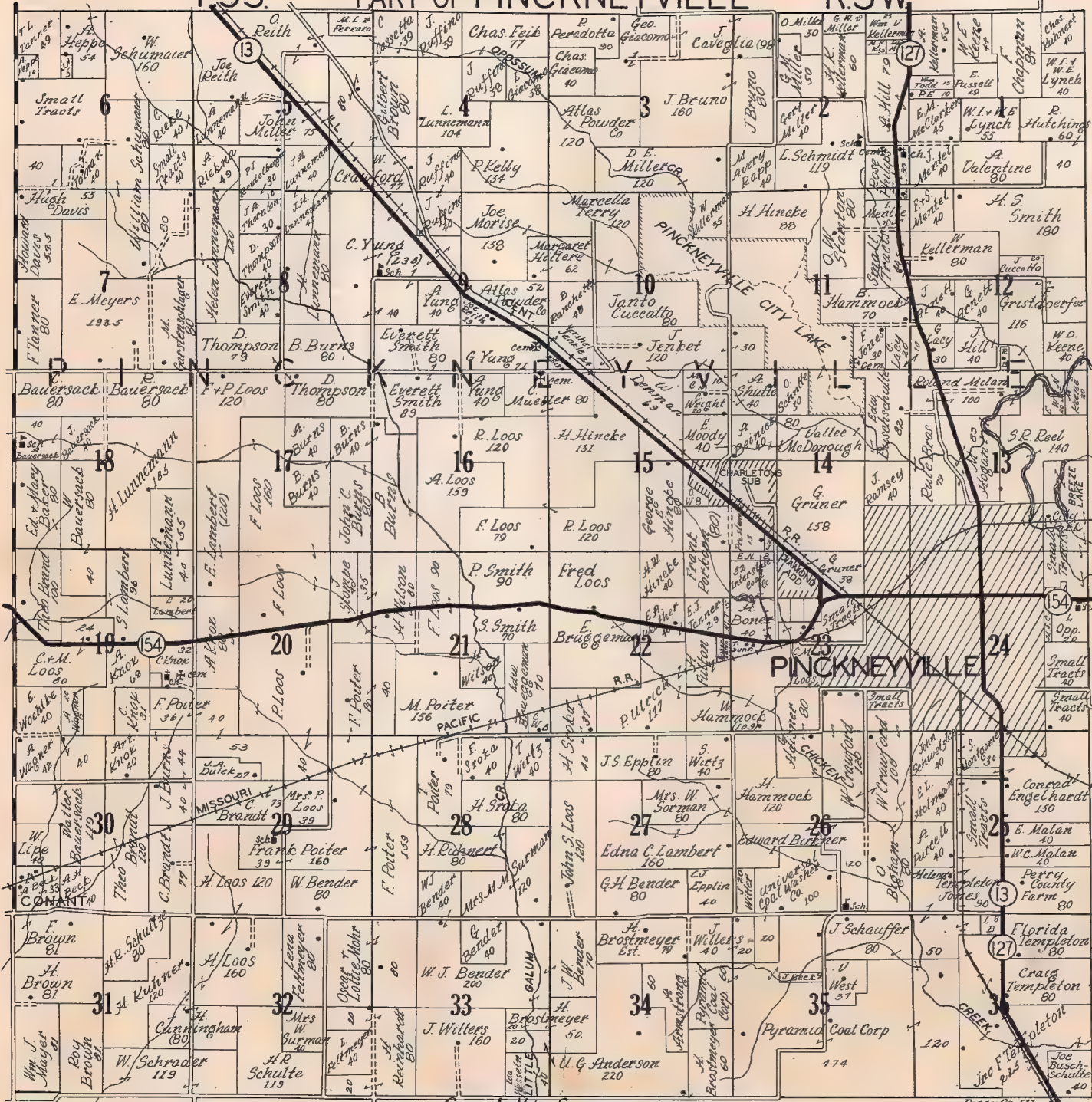

T. 5S. PARTS OF SWANWICK - CUTLER R. 4W.

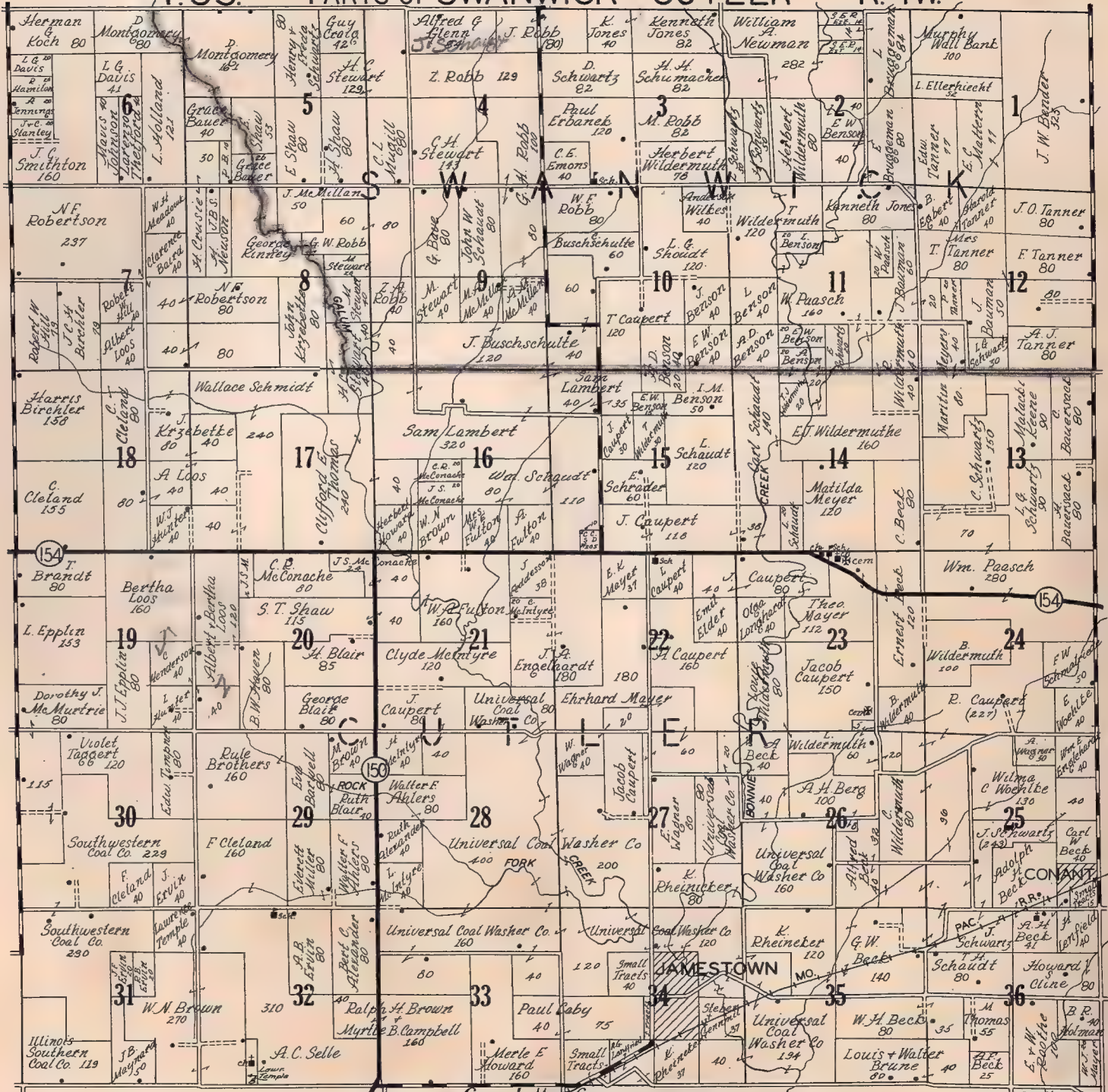

Handwritten numbers: 6, 8, 3, 7, 1

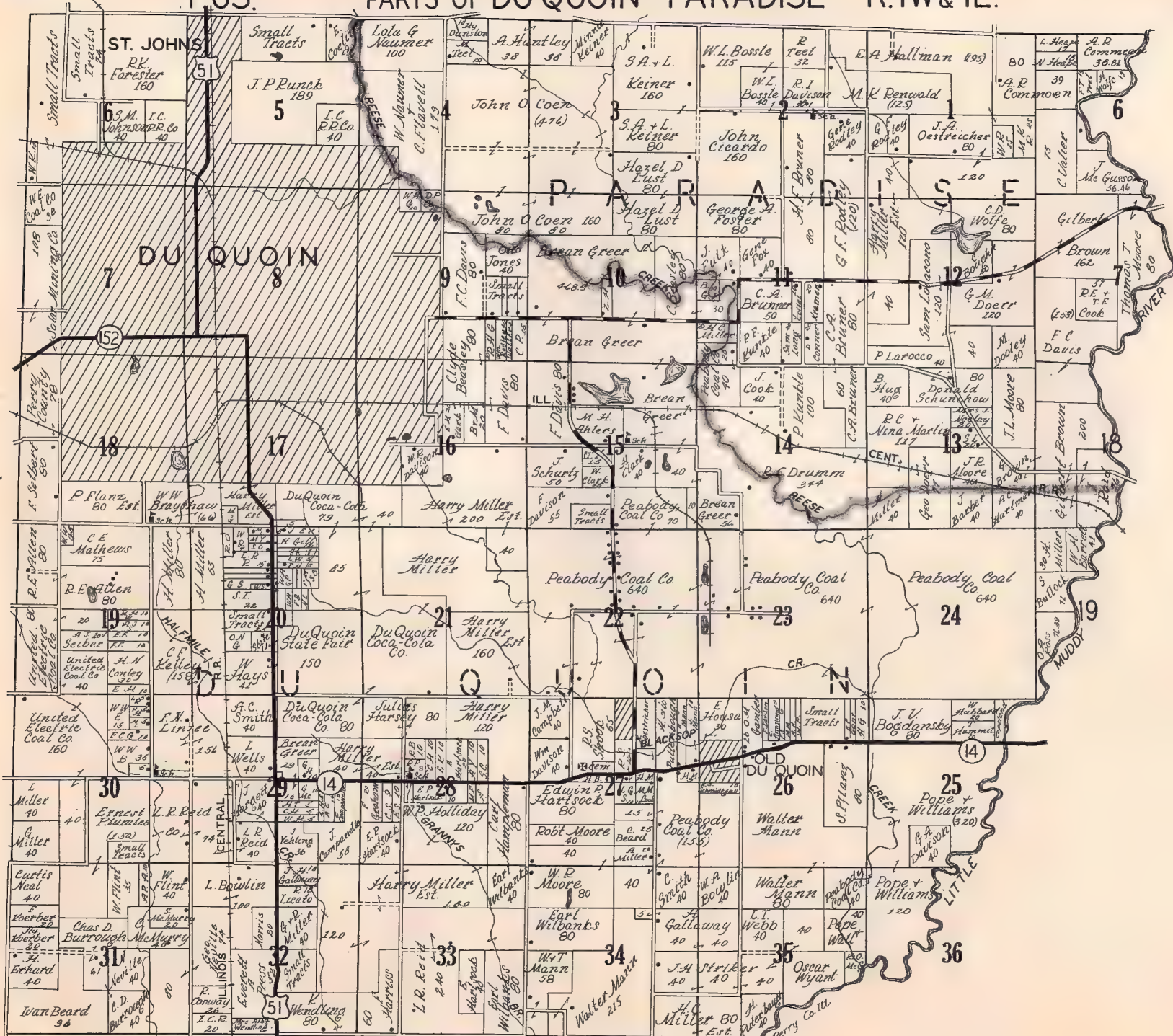

T.6S. PARTS OF DU QUOIN-PINCKNEYVILLE R.2W.

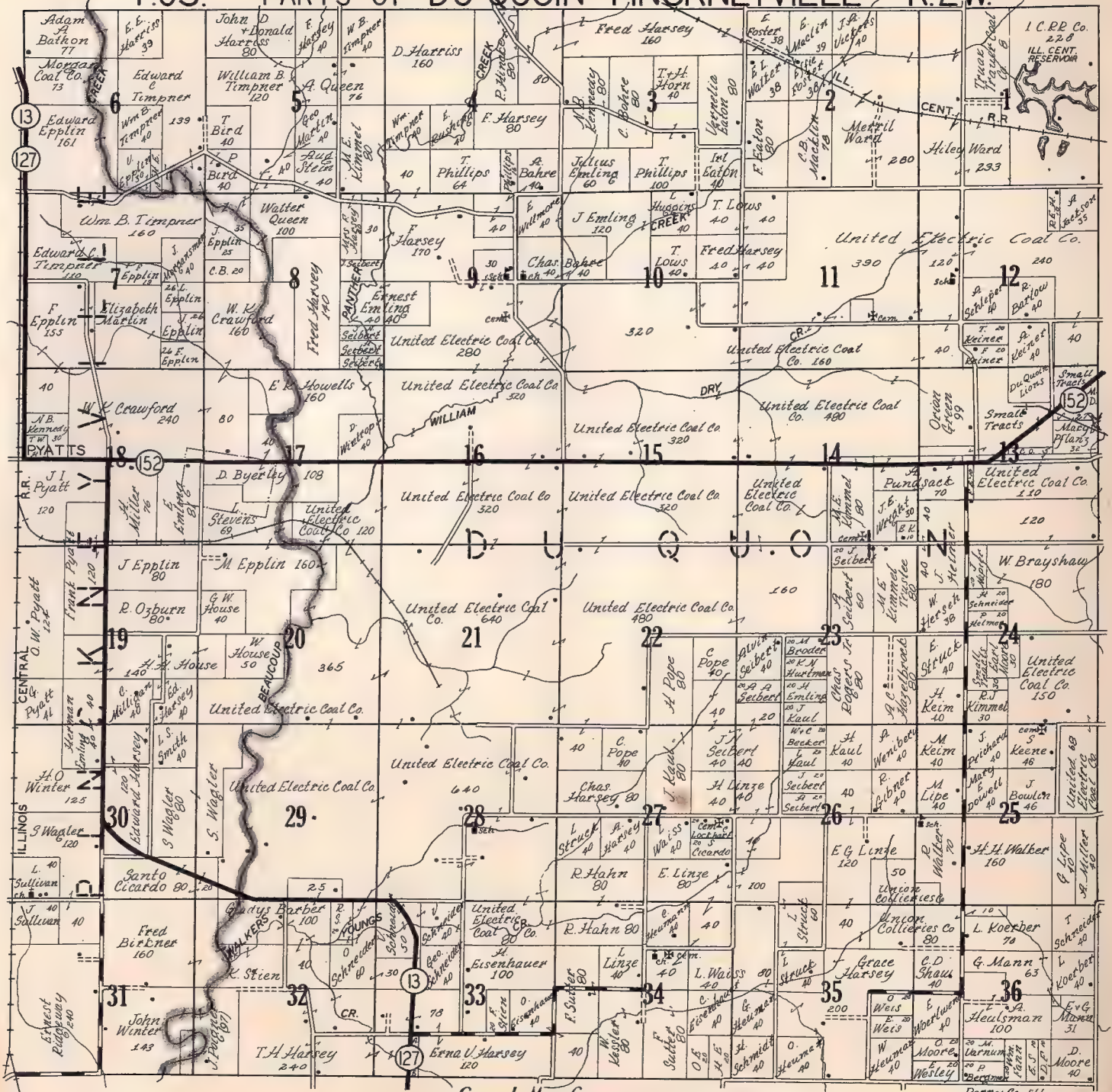

T. 6 S. PARTS OF PINCKNEYVILLE - DENMARK R. 3 W.



T.6S. WILLISVILLE & PART OF CUTLER & DENMARK R.4W. 15

